

[NK] 3 copies of Preliminary Stability Booklet are to be submitted in accordance with Part B 2.1.2.3 of Codebook for the Survey and Construction of Steel Ships.

PRINCIPAL PARTICULAR

- L. O. A. :- 24.45 M (80.22 FT)
- L. B. P. :- 22.95 M (73.15 FT)
- BEAM MLD :- 7.32 M (24.00 FT)
- DEPTH MLD :- 3.35 M (11.00 FT)
- DESIGNED DRAFT:- 2.85 M (9.35 FT)
- CREWS :- 10 MEN
- FUEL OIL :- 119.00 M³ (100 % FULL)
- FRESH WATER :- 30.00 M³ (100 % FULL)
- BALLAST :- 26.00 M³ (100 % FULL)
- DIRTY OIL TANK :- 1.85 M³ (100 % FULL)
- MAIN ENGINE :- 2 X CUMMINS KTA19-M3
600 BHP / 1800 RPM EACH
- GEAR BOX :- TWIN DISC MG 5170
5.95 : 1 RATIO
- GENERATOR :- 2 X 24 KW EACH
- SPEED :- 10 KNOTS (FREE RUNNING)
- DESIGNED B. P. :- 16 TONNES (APPROXIMATE)

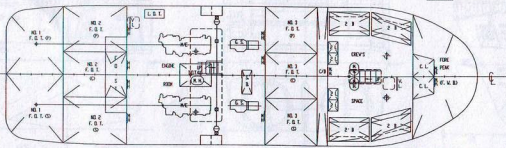
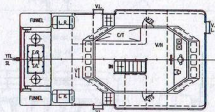
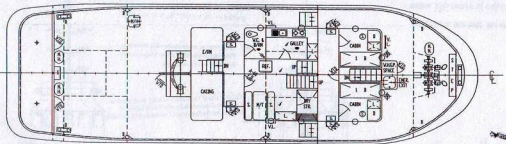

NOTES

- ✓ 1- DK. PLATE BETWEEN F.O.T. AND ACC. SP. TO BE COVERED BY INCOMBUSTIBLE MATERIALS.

(1/2) With Remarks in Red

[NK] L by NK Rules: ≈ 0.824 m
[NK] ds : ≈ 0.850 m

REGIONAL MANAGER
SOUTH ASIA AND OCEANIA

DATE	MODIFICATION	REV.	BY
20 DEC 2001			
WANG SANG & ASSOCIATES SDN. BHD.			
CORPORATE ARCHITECTURE			
MARINE DESIGN ENGINEERING & SUPERVISION			
2nd FLOOR, 42, LORONG JANG KANG, TAMAN			
REPS L.P. 06, 102, SINGAPORE			
SIRI, SINGAPORE, MALAYSIA			
TELE: 664-25000, 25000 FAX: 664-20000			
EMAIL: ms@wsc.com.sg			
24M T. S. TUG			
GENERAL ARRANGEMENT			
OWNER	DESIGNER	SCALE	REV.
SARAWAK SHIPPING CO. (SAR) LTD.	WANG SANG & ASSOCIATES SDN. BHD.	1 : 100	
CLASS	DESIGNATED AREA	SCALE	REV.
NO. 100	ENGINE ROOM	1 : 100	
DATE	BY	REV.	BY
20-12-2001	WANG SANG	1	WANG SANG

This drawing and the information contained herein is supplied on the understanding that they are the exclusive property of WANG SANG & ASSOCIATES SDN. BHD. and shall not be used or reproduced in whole or in part without permission in writing.