

[NK] 3 copies of Preliminary Stability Booklet are to be submitted in accordance with Part B 2.1.2.3 of Codebook for the Survey and Construction of Steel Ships.

**PRINCIPAL PARTICULAR**

- L. O. A. 24.45 M (80.22 FT)
- L. B. P. 22.95 M (73.15 FT)
- BEAM MLD 7.32 M (24.00 FT)
- DEPTH MLD 3.35 M (11.00 FT)
- DESIGNED DRAFT 2.85 M ( 9.35 FT)
- CREWS 10 MEN
- FUEL OIL 119.00 M<sup>3</sup> (100 % FULL)
- FRESH WATER 30.00 M<sup>3</sup> (100 % FULL)
- BALLAST 26.00 M<sup>3</sup> (100 % FULL)
- DIRTY OIL TANK 1.85 M<sup>3</sup> (100 % FULL)
- MAIN ENGINE 2 X CUMMINS KTA19-M3  
600 BHP / 1800 RPM EACH
- GEAR BOX 1 TWIN DISC MG 5170  
5.95 : 1 RATIO
- GENERATOR 2 X 24 KW EACH
- SPEED 10 KNOTS (FREE RUNNING)
- DESIGNED B. P. 16 TONNES (APPROXIMATE)

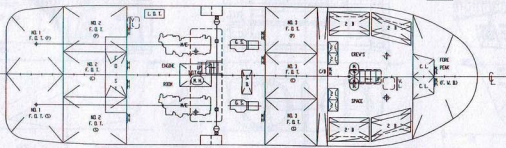
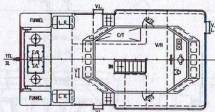
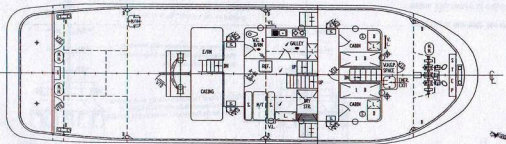

**NOTES**

- ✓ 1- DK. PLATE BETWEEN F.O.T. AND ACC. SP. TO BE COVERED BY INCOMBUSTIBLE MATERIALS.

(1/2) With Remarks in Red

[NK] L by NK Rules:  $\approx 0.824$  m  
[NK] ds :  $\approx 0.850$  m

REGIONAL MANAGER  
SOUTH ASIA AND OCEANIA

DATE	MODIFICATION	REV.	BY
20 DEC 2001			
<b>WANG SANG &amp; ASSOCIATES SDN. BHD.</b>			
CORPORATE ARCHITECTURE			
MARINE DESIGN ENGINEERING & SUPERVISION			
2nd FLOOR, 4C, LORONG JANG KANG, SAKAI 1			
OFFICE NO. 06, 1ST FLOOR, SAKAI			
SIBU, SARAWAK, MALAYSIA			
TELE: 084-250200, 250201, 250202 FAX: 084-250208			
EMAIL: <a href="mailto:ms@wsg.com.my">ms@wsg.com.my</a>			
<b>24M T. S. TUG</b>			
<b>GENERAL ARRANGEMENT</b>			
DRAWN	CHECKED	DATE	BY
SAHARANG SUPRIATY S.P.A. SAKAI	TS. NG	20040505	SAHARANG
CLASS	NO. OF SHEET	TOTAL SHEETS	REV.
UNDESIGNATED AREA	1	1	0
SCALE	DATE	BY	REV.
1:100	10-2-2001	1:100	WSD000-01-C

This drawing and the information contained herein is supplied on the understanding that they are the exclusive property of WANG SANG & ASSOCIATES SDN. BHD. and shall not be used or reproduced in whole or in part without permission in writing.